

LOCATION MAP
PROJECT NO. 0085-0146
ROUTE 85 IMPROVEMENTS SOUTH OF ROUTE 82
TOWNS OF SALEM AND MONTVILLE

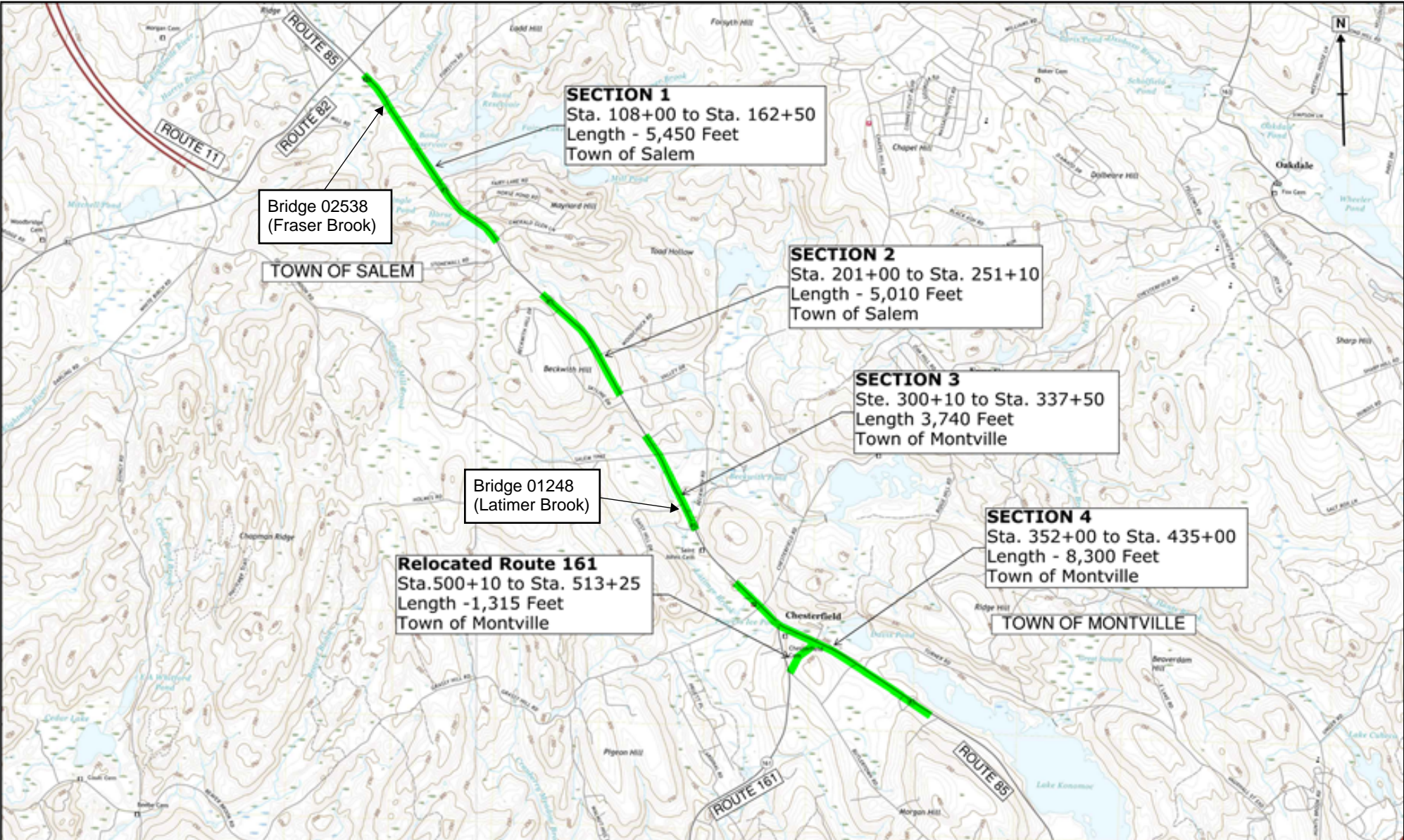

SEGMENT 1 - TOWN OF SALEM SIGNING & PAVEMENT MARKING PLAN

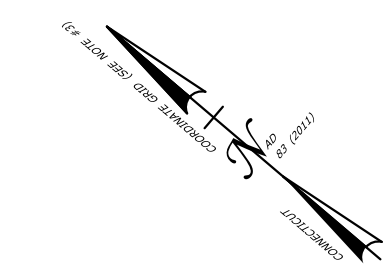

SIGNING STANDARD CONVENTIONS	
	OVERHEAD INSTALLATION
	CANTILEVER INSTALLATION
	SIDE MOUNTED INSTALLATION
	REGULATORY, WARNING OR GUIDE SIGN INSTALLATION
	REGULATORY, WARNING OR GUIDE SIGN INSTALLATION
	AS NOTED - (16H,16E CONSTRUCTION IDENTIFICATION SIGNS)
	SIDE MOUNTED EXTRUDED ALUMINUM SIGN
	SINGLE POST MOUNTING SHEET ALUMINUM BACK TO BACK
	DOUBLE POST MOUNTING SHEET ALUMINUM BACK TO BACK
	SIDE MOUNTED EXTRUDED ALUMINUM SIGN BACK TO BACK
00-000-00	LOCATION NO. EXTRUDED ALUMINUM SIGNS
00-00-0	LOCATION NO. SIGN NO.

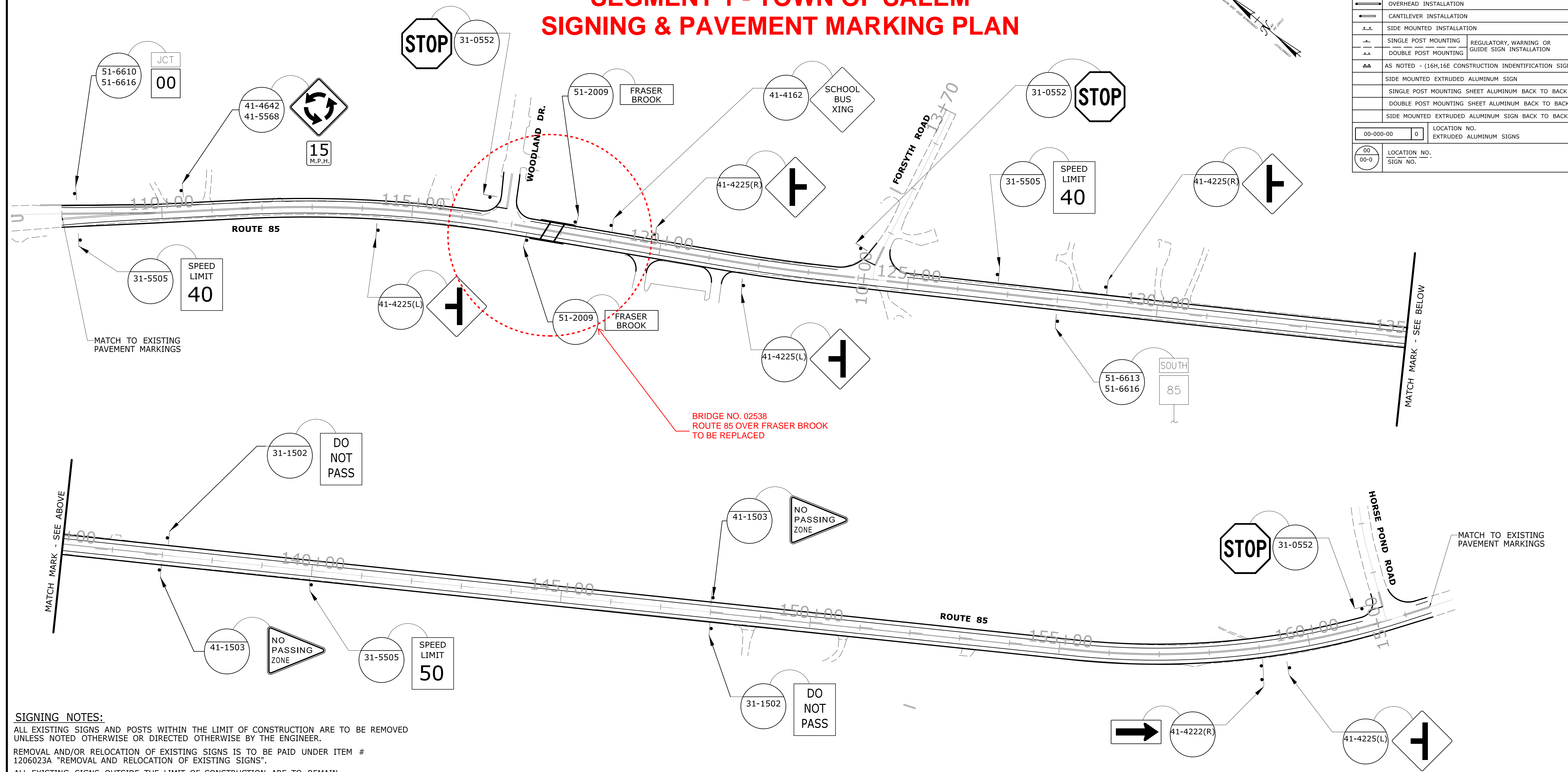

BRIDGE NO. 02538
ROUTE 85 OVER FRASER BROOK
TO BE REPLACED

SIGNING NOTES:
 ALL EXISTING SIGNS AND POSTS WITHIN THE LIMIT OF CONSTRUCTION ARE TO BE REMOVED UNLESS NOTED OTHERWISE OR DIRECTED OTHERWISE BY THE ENGINEER.
 REMOVAL AND/OR RELOCATION OF EXISTING SIGNS IS TO BE PAID UNDER ITEM # 1206023A "REMOVAL AND RELOCATION OF EXISTING SIGNS".
 ALL EXISTING SIGNS OUTSIDE THE LIMIT OF CONSTRUCTION ARE TO REMAIN. EXACT SIGN LOCATIONS TO BE VERIFIED BY THE ENGINEER.
 THE CONTRACTOR SHALL TRIM BRANCHES AS NECESSARY TO PROVIDE ADEQUATE SIGHTLINE TO SIGNS. THIS IS TO BE PAID FOR UNDER THE ITEM "CLEARING AND GRUBBING."
 ALL SIGNS TO BE NEW EXCEPT WHERE NOTED OTHERWISE.

PAVEMENT MARKING NOTES:
 THE STATE SHALL MAINTAIN ALL PAVEMENT MARKINGS ON ROUTE 85 AND ALL STOP BARS.

LEGEND
 RELOCATE EXISTING SIGN(S) ON NEW POSTS

** SEE SIGNAL PLAN FOR EXACT LOCATION

PRELIMINARY DESIGN REVIEW

	DESIGNER/DRAFTER: S. ULMAN	 STATE OF CONNECTICUT DEPARTMENT OF TRANSPORTATION	SIGNATURE/ BLOCK:	PROJECT TITLE: ROUTE 85 SPOT/SAFETY IMPROVEMENTS	TOWN: SALEM	PROJECT NO. 85-146
	CHECKED BY: J. KOERNER				DRAWING TITLE: SIGNING PLAN	DRAWING NO. SGN-01
REV. DATE REVISION DESCRIPTION SHEET NO.	Plotted Date: 8/5/2021	SCALE IN FEET 0 100 200 SCALE 1"=100'	Filename: ...HW_MSH_85_146_1_SGN-01.dgn			SHEET NO. 04.04

SEGMENT 2 - TOWN OF SALEM SIGNING & PAVEMENT MARKING PLAN

SIGNING STANDARD CONVENTIONS		
	OVERHEAD INSTALLATION	
	CANTILEVER INSTALLATION	
	SIDE MOUNTED INSTALLATION	
	SINGLE POST MOUNTING	REGULATORY, WARNING OR GUIDE SIGN INSTALLATION
	DOUBLE POST MOUNTING	REGULATORY, WARNING OR GUIDE SIGN INSTALLATION
	AS NOTED - (16H,16E CONSTRUCTION IDENTIFICATION SIGNS)	
	SIDE MOUNTED EXTRUDED ALUMINUM SIGN	
	SINGLE POST MOUNTING SHEET ALUMINUM BACK TO BACK	
	DOUBLE POST MOUNTING SHEET ALUMINUM BACK TO BACK	
	SIDE MOUNTED EXTRUDED ALUMINUM SIGN BACK TO BACK	
	LOCATION NO.	
00-000-00	0	
	LOCATION NO. & SIGN NO.	
00-0	00-0	

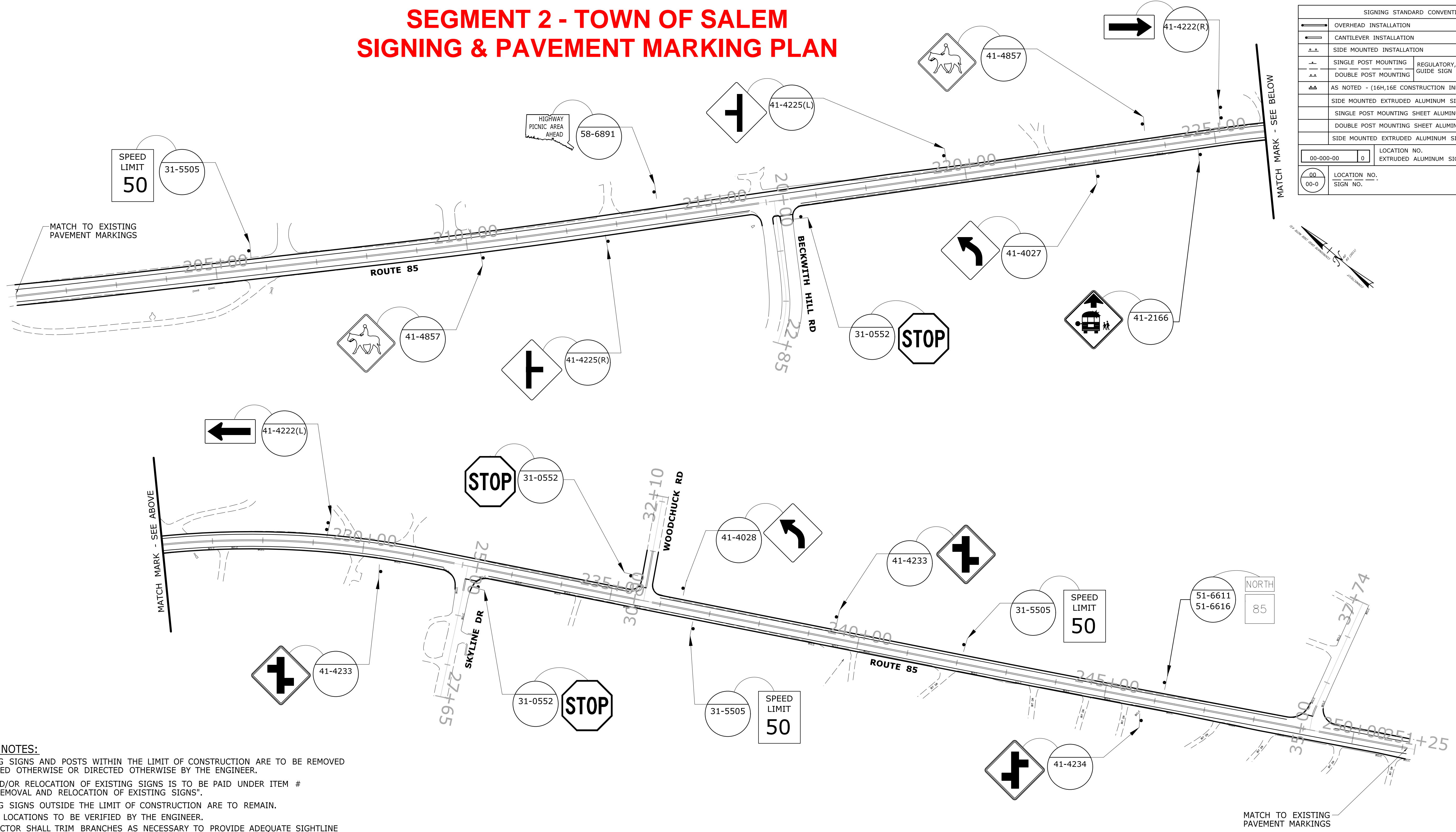

SIGNING NOTES:
 ALL EXISTING SIGNS AND POSTS WITHIN THE LIMIT OF CONSTRUCTION ARE TO BE REMOVED UNLESS NOTED OTHERWISE OR DIRECTED OTHERWISE BY THE ENGINEER.
 REMOVAL AND/OR RELOCATION OF EXISTING SIGNS IS TO BE PAID UNDER ITEM # 1206023A "REMOVAL AND RELOCATION OF EXISTING SIGNS".
 ALL EXISTING SIGNS OUTSIDE THE LIMIT OF CONSTRUCTION ARE TO REMAIN.
 EXACT SIGN LOCATIONS TO BE VERIFIED BY THE ENGINEER.
 THE CONTRACTOR SHALL TRIM BRANCHES AS NECESSARY TO PROVIDE ADEQUATE SIGHTLINE TO SIGNS. THIS IS TO BE PAID FOR UNDER THE ITEM "CLEARING AND GRUBBING."
 ALL SIGNS TO BE NEW EXCEPT WHERE NOTED OTHERWISE.

PAVEMENT MARKING NOTES:
 THE STATE SHALL MAINTAIN ALL PAVEMENT MARKINGS ON ROUTE 85 AND ALL STOP BARS.

- ◆ RELOCATE EXISTING SIGN(S) ON NEW POSTS
- ** SEE SIGNAL PLAN FOR EXACT LOCATION

PRELIMINARY DESIGN REVIEW

<table border="1" style="width: 100%; border-collapse: collapse;"> <thead> <tr> <th>REV.</th> <th>DATE</th> <th>REVISION DESCRIPTION</th> <th>SHEET NO.</th> </tr> </thead> <tbody> <tr> <td> </td> <td> </td> <td> </td> <td> </td> </tr> </tbody> </table>	REV.	DATE	REVISION DESCRIPTION	SHEET NO.					THE INFORMATION, INCLUDING ESTIMATED QUANTITIES OF WORK, SHOWN ON THESE SHEETS IS BASED ON LIMITED INVESTIGATIONS BY THE STATE AND IS IN NO WAY WARRANTED TO INDICATE THE CONDITIONS OF ACTUAL QUANTITIES OF WORK WHICH WILL BE REQUIRED. Plotted Date: 8/5/2021	DESIGNER/DRAFTER: S. ULMAN CHECKED BY: J. KOERNER <div style="text-align: center;"> STATE OF CONNECTICUT DEPARTMENT OF TRANSPORTATION </div> SCALE IN FEET SCALE 1"=100' <small>Filename: ...JHW_MSH_85_146_1_SGN-02.dgn</small>	SIGNATURE/BLOCK: <div style="text-align: center;"> ROUTE 85 SPOT/SAFETY IMPROVEMENTS </div>	PROJECT TITLE: <div style="text-align: center;"> ROUTE 85 SPOT/SAFETY IMPROVEMENTS </div>	TOWN: <div style="text-align: center;"> SALEM </div> DRAWING TITLE: <div style="text-align: center;"> SIGNING PLAN </div>	PROJECT NO. 85-146 DRAWING NO. SGN-02 SHEET NO. 04.05
REV.	DATE	REVISION DESCRIPTION	SHEET NO.											

SEGMENT 3 - TOWN OF MONTVILLE SIGNING & PAVEMENT MARKING PLAN

SIGNING STANDARD CONVENTIONS		
	OVERHEAD INSTALLATION	
	CANTILEVER INSTALLATION	
	SIDE MOUNTED INSTALLATION	
	SINGLE POST MOUNTING	REGULATORY, WARNING OR
	DOUBLE POST MOUNTING	GUIDE SIGN INSTALLATION
	AS NOTED - (16H,16E CONSTRUCTION IDENTIFICATION SIGNS)	
	SIDE MOUNTED EXTRUDED ALUMINUM SIGN	
	SINGLE POST MOUNTING SHEET ALUMINUM BACK TO BACK	
	DOUBLE POST MOUNTING SHEET ALUMINUM BACK TO BACK	
	SIDE MOUNTED EXTRUDED ALUMINUM SIGN BACK TO BACK	
	LOCATION NO. 00-000-00	
	LOCATION NO. 00-0	
	SIGN NO.	

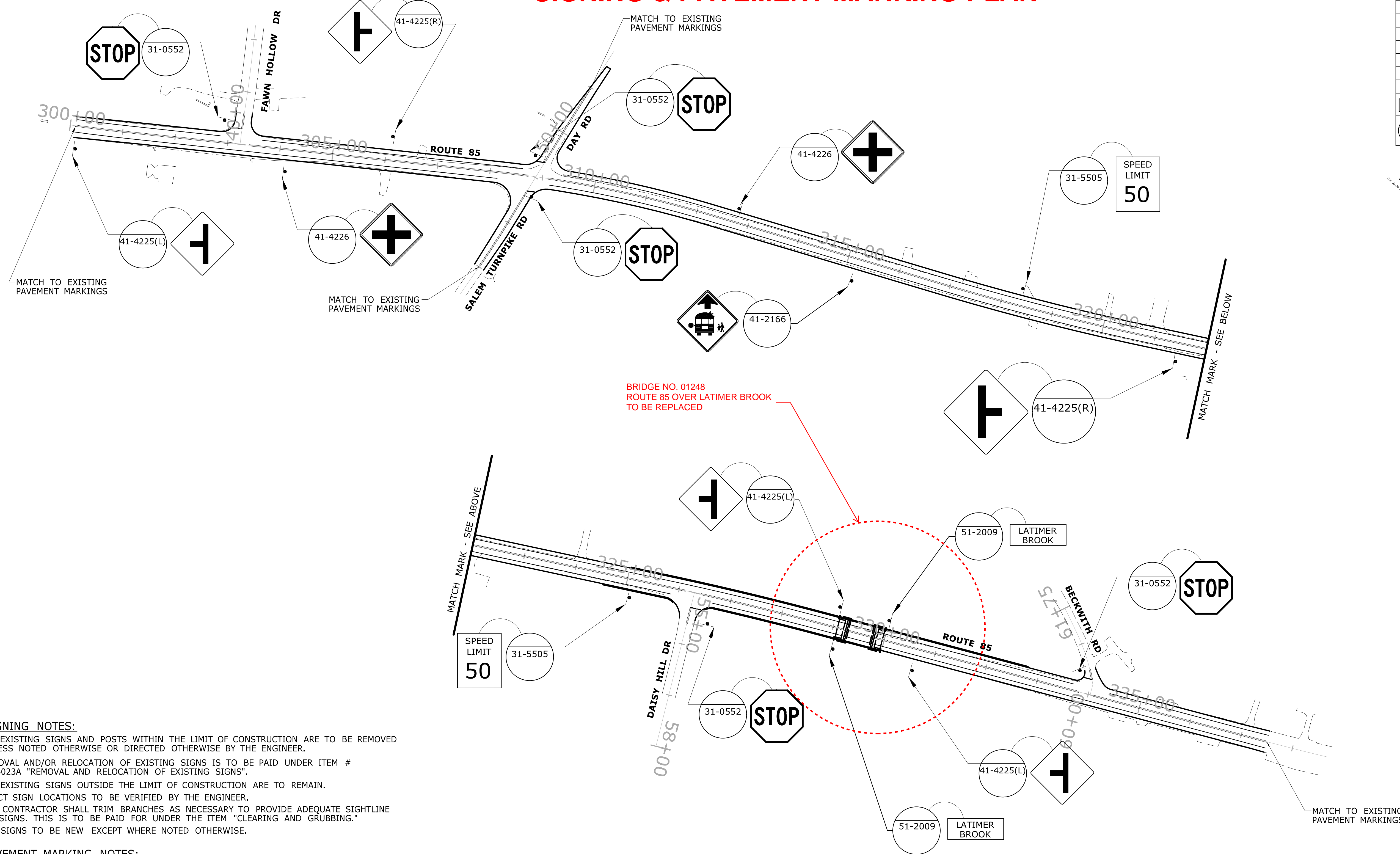

SIGNING NOTES:
 ALL EXISTING SIGNS AND POSTS WITHIN THE LIMIT OF CONSTRUCTION ARE TO BE REMOVED UNLESS NOTED OTHERWISE OR DIRECTED OTHERWISE BY THE ENGINEER.
 REMOVAL AND/OR RELOCATION OF EXISTING SIGNS IS TO BE PAID UNDER ITEM # 1206023A "REMOVAL AND RELOCATION OF EXISTING SIGNS".
 ALL EXISTING SIGNS OUTSIDE THE LIMIT OF CONSTRUCTION ARE TO REMAIN.
 EXACT SIGN LOCATIONS TO BE VERIFIED BY THE ENGINEER.
 THE CONTRACTOR SHALL TRIM BRANCHES AS NECESSARY TO PROVIDE ADEQUATE SIGHTLINE TO SIGNS. THIS IS TO BE PAID FOR UNDER THE ITEM "CLEARING AND GRUBBING."
 ALL SIGNS TO BE NEW EXCEPT WHERE NOTED OTHERWISE.

PAVEMENT MARKING NOTES:
 THE STATE SHALL MAINTAIN ALL PAVEMENT MARKINGS ON ROUTE 85 AND ALL STOP BARS.

- ◆ RELOCATE EXISTING SIGN(S) ON NEW POSTS
- ** SEE SIGNAL PLAN FOR EXACT LOCATION

PRELIMINARY DESIGN REVIEW

	DESIGNER/DRAFTER: S. ULMAN	 STATE OF CONNECTICUT DEPARTMENT OF TRANSPORTATION	SIGNATURE/ BLOCK:	PROJECT TITLE: ROUTE 85 SPOT/SAFETY IMPROVEMENTS	TOWN: MONTVILLE / SALEM	PROJECT NO. 85-146
	CHECKED BY: J. KOERNER	 SCALE 1"=100' <small>Filename: ...JHW_MSH_85_146_1_SGN-03.dgn</small>			DRAWING TITLE: SIGNING PLAN	DRAWING NO. SGN-03
REV. DATE REVISION DESCRIPTION SHEET NO.	Plotted Date: 8/5/2021					SHEET NO. 04.06

SEGMENT 4 - TOWN OF MONTVILLE SIGNING & PAVEMENT MARKING PLAN

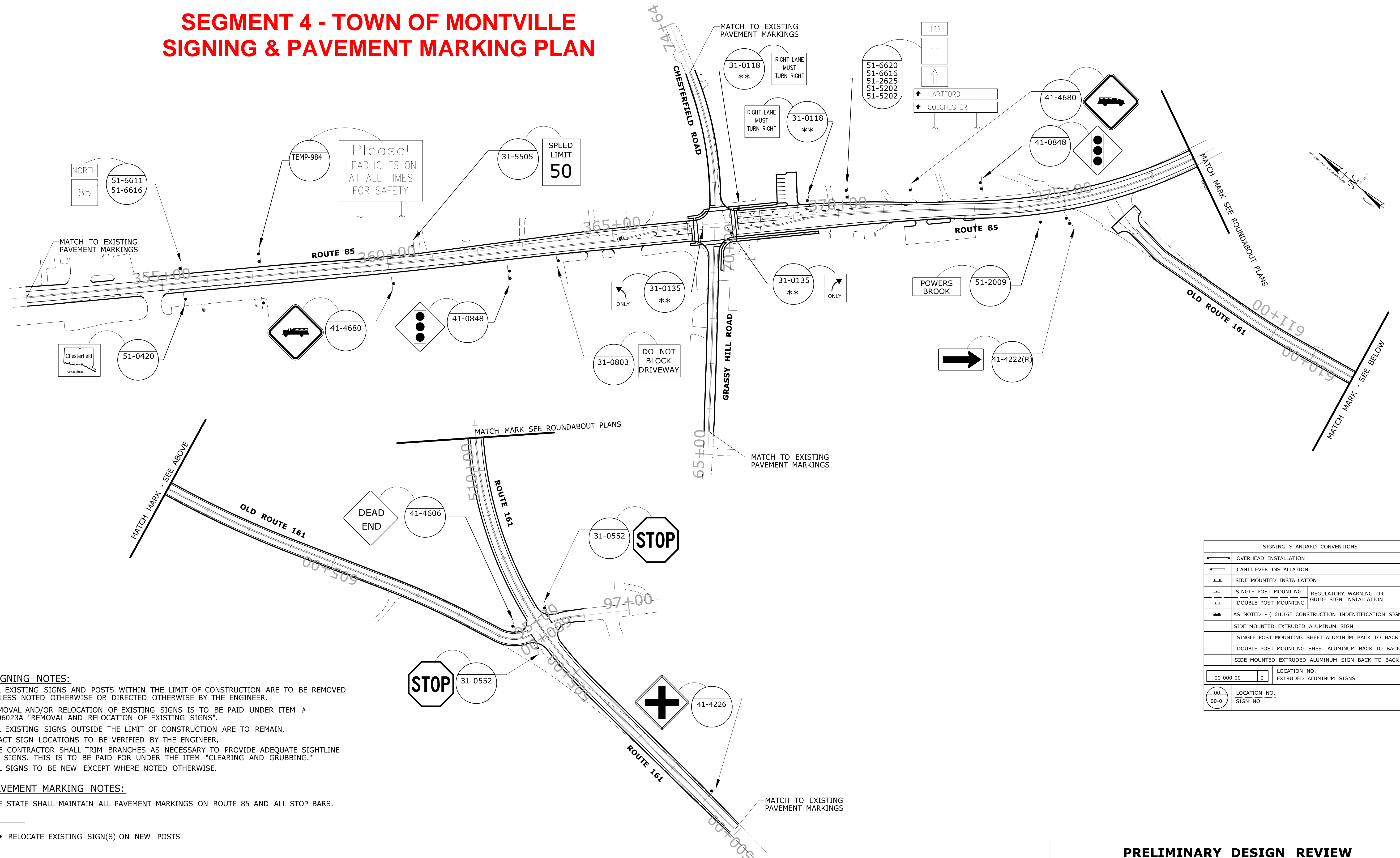

SIGNING NOTES:
 ALL EXISTING SIGNS AND POSTS WITHIN THE LIMIT OF CONSTRUCTION ARE TO BE REMOVED UNLESS NOTED OTHERWISE OR DIRECTED OTHERWISE BY THE ENGINEER.
 REMOVAL AND/OR RELOCATION OF EXISTING SIGNS IS TO BE PAID UNDER ITEM # 1206023A "REMOVAL AND RELOCATION OF EXISTING SIGNS".
 ALL EXISTING SIGNS OUTSIDE THE LIMIT OF CONSTRUCTION ARE TO REMAIN.
 EXACT SIGN LOCATIONS TO BE VERIFIED BY THE ENGINEER.
 THE CONTRACTOR SHALL TRIM BRANCHES AS NECESSARY TO PROVIDE ADEQUATE SIGHTLINE TO SIGNS. THIS IS TO BE PAID FOR UNDER THE ITEM "CLEARING AND GRUBBING."
 ALL SIGNS TO BE NEW EXCEPT WHERE NOTED OTHERWISE.

PAVEMENT MARKING NOTES:
 THE STATE SHALL MAINTAIN ALL PAVEMENT MARKINGS ON ROUTE 85 AND ALL STOP BARS.

- ◆ RELOCATE EXISTING SIGN(S) ON NEW POSTS
- ** SEE SIGNAL PLAN FOR EXACT LOCATION

SIGNING STANDARD CONVENTIONS	
	OVERHEAD INSTALLATION
	CANTILEVER INSTALLATION
	SIDE MOUNTED INSTALLATION
	SINGLE POST MOUNTING
	DOUBLE POST MOUNTING
	REGULATORY, WARNING OR GUIDE SIGN INSTALLATION
	AS NOTED - (16H,16E CONSTRUCTION IDENTIFICATION SIGNS)
	SIDE MOUNTED EXTRUDED ALUMINUM SIGN
	SINGLE POST MOUNTING SHEET ALUMINUM BACK TO BACK
	DOUBLE POST MOUNTING SHEET ALUMINUM BACK TO BACK
	SIDE MOUNTED EXTRUDED ALUMINUM SIGN BACK TO BACK
	LOCATION NO.
	EXTRUDED ALUMINUM SIGNS
	LOCATION NO. & SIGN NO.

PRELIMINARY DESIGN REVIEW

	DESIGNER/DRAFTER: S. ULMAN	 STATE OF CONNECTICUT DEPARTMENT OF TRANSPORTATION	PROJECT TITLE: ROUTE 85 SPOT/SAFETY IMPROVEMENTS	TOWN: MONTVILLE	PROJECT NO. 85-146 DRAWING NO. SGN-04 SHEET NO. 04.07
REV.	DATE	REVISION DESCRIPTION	SHEET NO.	DRAWING TITLE: SIGNING PLAN	
		Plotted Date: 8/5/2021			
		SCALE IN FEET 0 100 200 SCALE 1"=100'	SIGNATURE/BLOCK:		Filename: ...\\HW_MSH_85_146_1_SGN-04.dgn

SEGMENT 4 (cont.) - TOWN OF MONTVILLE SIGNING & PAVEMENT MARKING PLAN

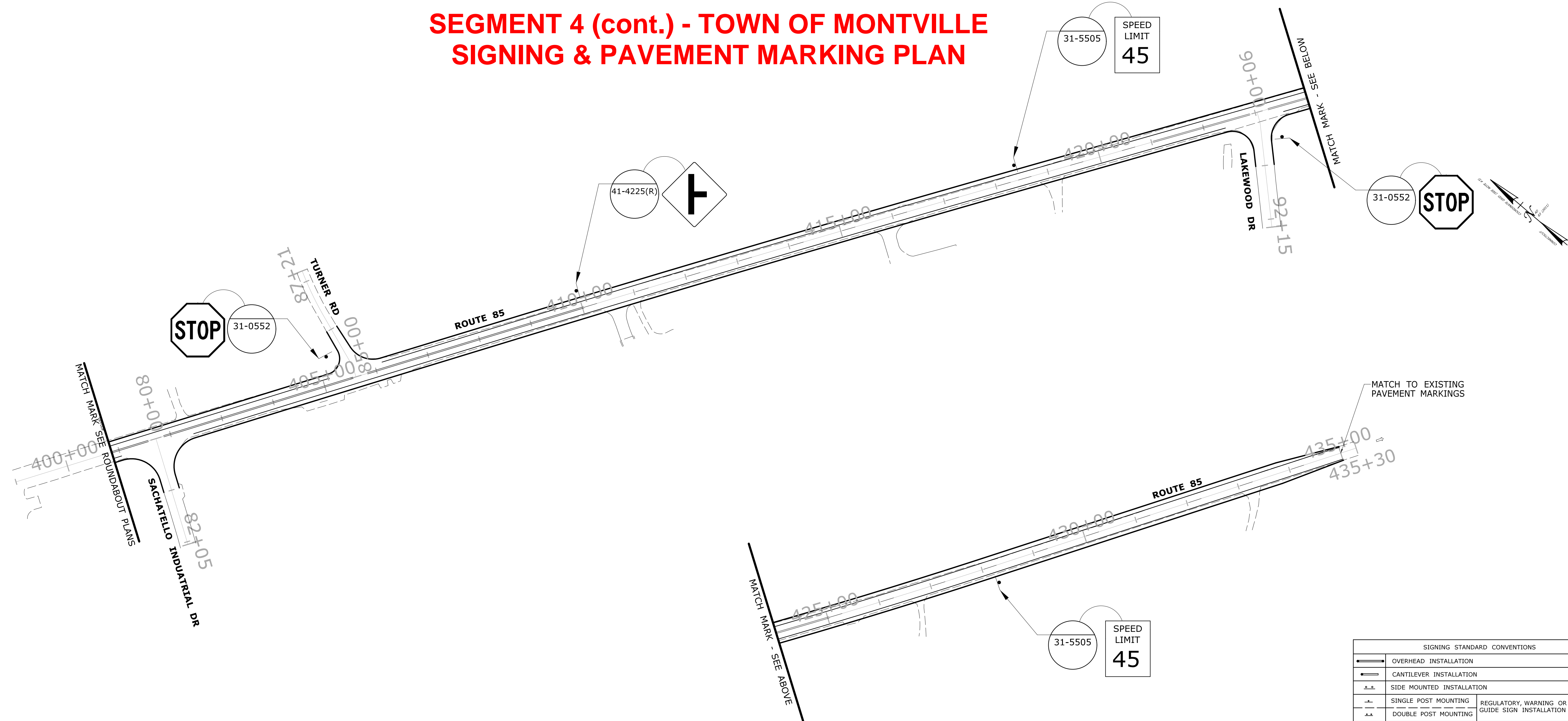

SIGNING NOTES:

ALL EXISTING SIGNS AND POSTS WITHIN THE LIMIT OF CONSTRUCTION ARE TO BE REMOVED UNLESS NOTED OTHERWISE OR DIRECTED OTHERWISE BY THE ENGINEER.

REMOVAL AND/OR RELOCATION OF EXISTING SIGNS IS TO BE PAID UNDER ITEM # 1206023A "REMOVAL AND RELOCATION OF EXISTING SIGNS".

ALL EXISTING SIGNS OUTSIDE THE LIMIT OF CONSTRUCTION ARE TO REMAIN.

EXACT SIGN LOCATIONS TO BE VERIFIED BY THE ENGINEER.

THE CONTRACTOR SHALL TRIM BRANCHES AS NECESSARY TO PROVIDE ADEQUATE SIGHTLINE TO SIGNS. THIS IS TO BE PAID FOR UNDER THE ITEM "CLEARING AND GRUBBING."

ALL SIGNS TO BE NEW EXCEPT WHERE NOTED OTHERWISE.

PAVEMENT MARKING NOTES:

THE STATE SHALL MAINTAIN ALL PAVEMENT MARKINGS ON ROUTE 85 AND ALL STOP BARS.

◆ RELOCATE EXISTING SIGN(S) ON NEW POSTS

** SEE SIGNAL PLAN FOR EXACT LOCATION

SIGNING STANDARD CONVENTIONS	
	OVERHEAD INSTALLATION
	CANTILEVER INSTALLATION
	SIDE MOUNTED INSTALLATION
	SINGLE POST MOUNTING
	DOUBLE POST MOUNTING
	REGULATORY, WARNING OR GUIDE SIGN INSTALLATION
	AS NOTED - (16H,16E CONSTRUCTION IDENTIFICATION SIGNS)
	SIDE MOUNTED EXTRUDED ALUMINUM SIGN
	SINGLE POST MOUNTING SHEET ALUMINUM BACK TO BACK
	DOUBLE POST MOUNTING SHEET ALUMINUM BACK TO BACK
	SIDE MOUNTED EXTRUDED ALUMINUM SIGN BACK TO BACK
	LOCATION NO. EXTRUDED ALUMINUM SIGNS
	LOCATION NO. SIGN NO.

PRELIMINARY DESIGN REVIEW

	THE INFORMATION, INCLUDING ESTIMATED QUANTITIES OF WORK SHOWN ON THESE SHEETS IS BASED ON LIMITED INVESTIGATIONS BY THE STATE AND IS IN NO WAY WARRANTED TO INDICATE THE CONDITIONS OF ACTUAL QUANTITIES OF WORK WHICH WILL BE REQUIRED.	DESIGNER/DRAFTER: S. ULMAN CHECKED BY: J. KOERNER	 STATE OF CONNECTICUT DEPARTMENT OF TRANSPORTATION	SIGNATURE/ BLOCK:	PROJECT TITLE: <div style="text-align: center; font-weight: bold; font-size: 10px;"> ROUTE 85 SPOT/SAFETY IMPROVEMENTS </div>	TOWN: <div style="text-align: center; font-weight: bold; font-size: 10px;"> MONTVILLE </div>	PROJECT NO. 85-146 DRAWING NO. SGN-05 SHEET NO. 04.08								
SCALE IN FEET SCALE 1"=100'	Plotted Date: 8/5/2021	Filename: ...\\HW_MSH_85_146_1_SGN-05.dgn		DRAWING TITLE: <div style="text-align: center; font-weight: bold; font-size: 10px;"> SIGNING PLAN </div>											
<table border="1" style="width: 100%; border-collapse: collapse;"> <thead> <tr> <th style="width: 5%;">REV.</th> <th style="width: 10%;">DATE</th> <th style="width: 45%;">REVISION DESCRIPTION</th> <th style="width: 40%;">SHEET NO.</th> </tr> </thead> <tbody> <tr> <td> </td> <td> </td> <td> </td> <td> </td> </tr> </tbody> </table>	REV.	DATE	REVISION DESCRIPTION	SHEET NO.											
REV.	DATE	REVISION DESCRIPTION	SHEET NO.												

SEGMENT 4 (cont.) - TOWN OF MONTVILLE PRELIMINARY ROUNDABOUT PLAN

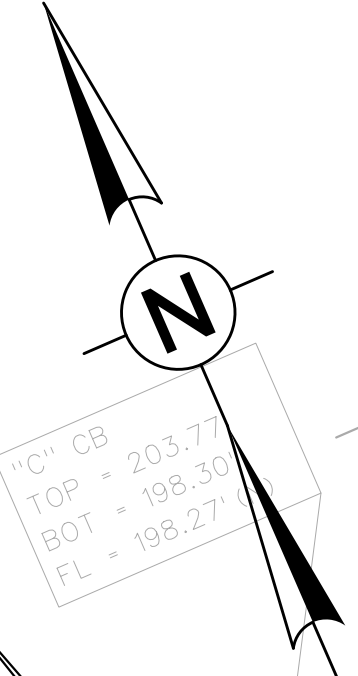
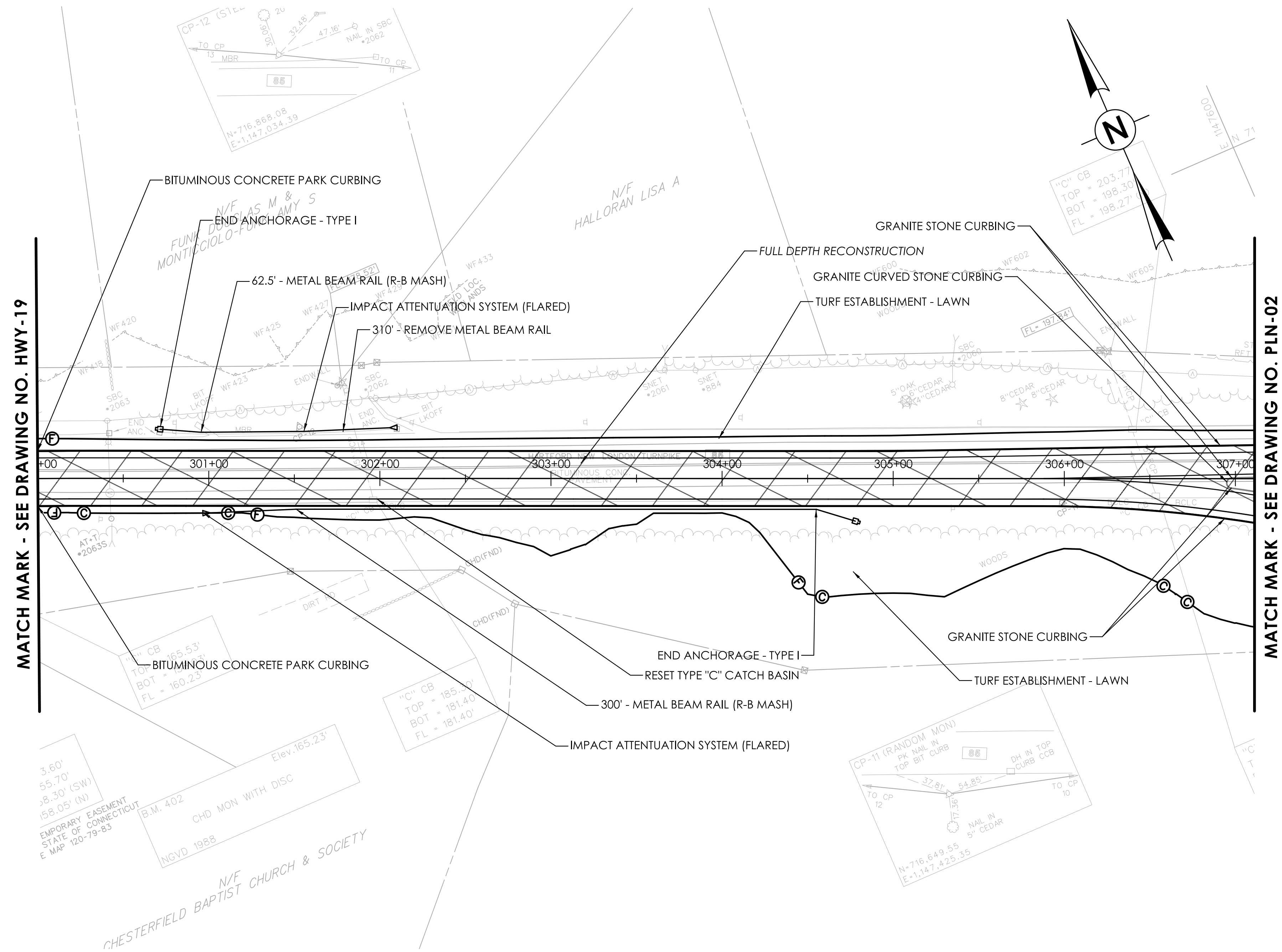

MATCH MARK - SEE DRAWING NO. HWY-19

MATCH MARK - SEE DRAWING NO. PLN-02

SEGMENT 4 (cont.) - TOWN OF MONTVILLE PRELIMINARY ROUNDABOUT PLAN

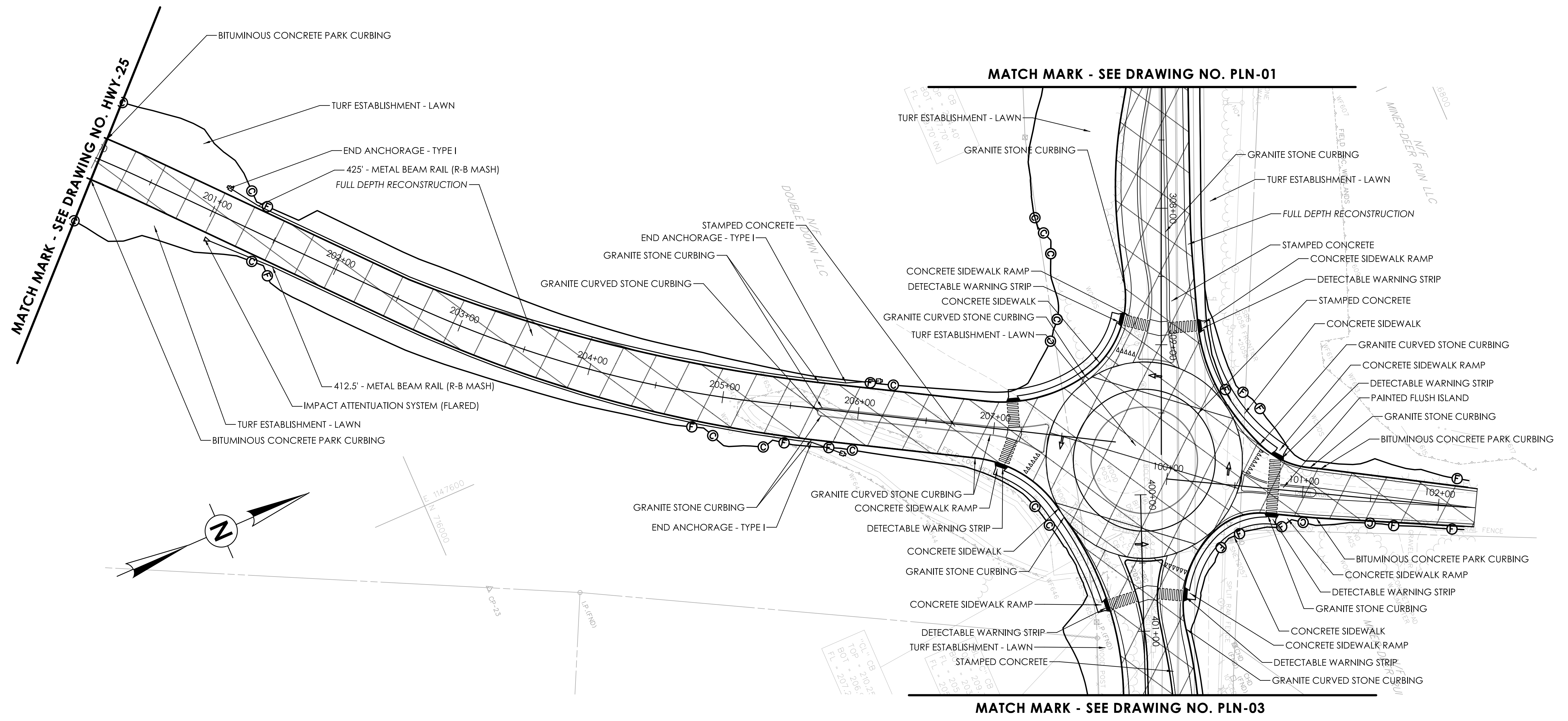

SEGMENT 4 (cont.) - TOWN OF MONTVILLE PRELIMINARY ROUNDABOUT PLAN

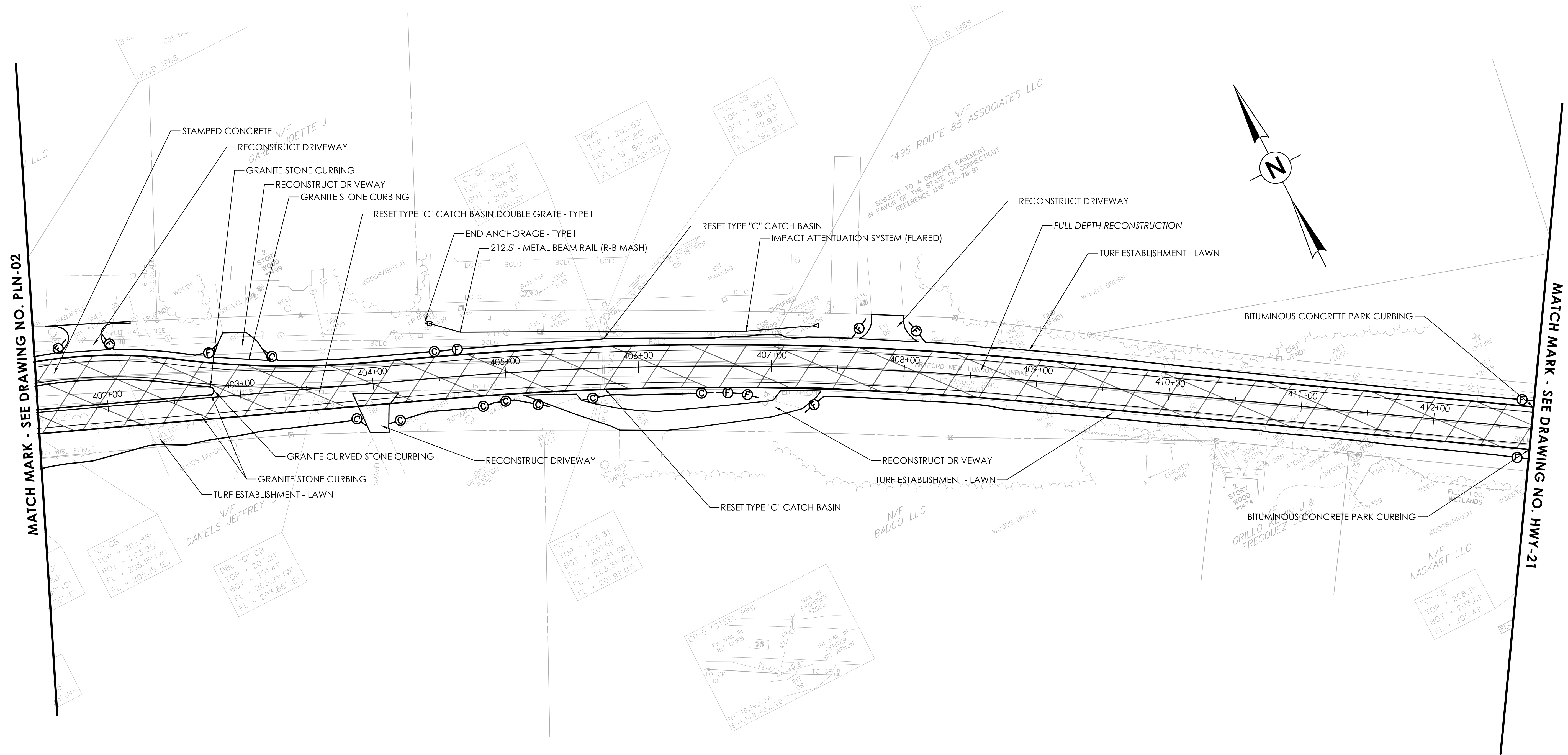

MATCH MARK - SEE DRAWING NO. PLN-02

MATCH MARK - SEE DRAWING NO. HWY-21